

# Royal cottages wall design

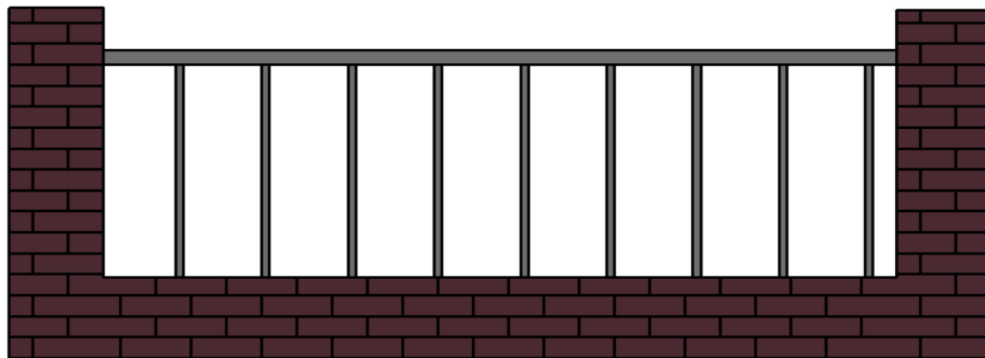

## Front walls

### Specification for Brickwork and Railing Installation

#### 1. Brick Type and Mortar Mix

Brick: Class B engineering bricks to be used throughout. Bricks must comply with BS EN 771-1 standards for strength, durability, and water absorption.

Mortar Mix: 3:1 sand to cement ratio. Mix must be well-graded building sand and Portland cement, mechanically mixed to a uniform consistency. Colouring agents may be added if required for aesthetic matching.

#### 2. Brick Laying Method

Joints to be 10mm /12mm thick, fully filled and tooled smooth. All brickwork to be level, plumb, and true to line.

#### 3. Brick Pillars

# Royal cottages wall design

Size: Each pillar to be 13 inches square (approx. 330mm x 330mm).

Spacing: Pillars to be constructed at 5 linear metre (5 lm) intervals along the run of the wall or railing.

Reinforcement: Vertical reinforcing bars to be incorporated in each pillar where applicable and filled with concrete grout for structural strength.

Capping: Each pillar to be finished with a pre-cast concrete or stone pillar cap, securely bedded with mortar.

## 4. Railings

Metal railings to be fixed between pillars.

Fixing Method: Railings to be securely installed using core drilling into the brickwork or concrete at specified anchor points.

Holes to be core-drilled to appropriate diameter and depth.

Use non-shrink grout or resin fixings to secure rail posts.

All railing units must be level and plumb, with consistent spacing between vertical bars.

## 5. General Requirements

All work to comply with relevant British Standards and Building Regulations, including:

BS 5628 for masonry structures.

BS EN 1996 for masonry design

## Royal cottages wall design

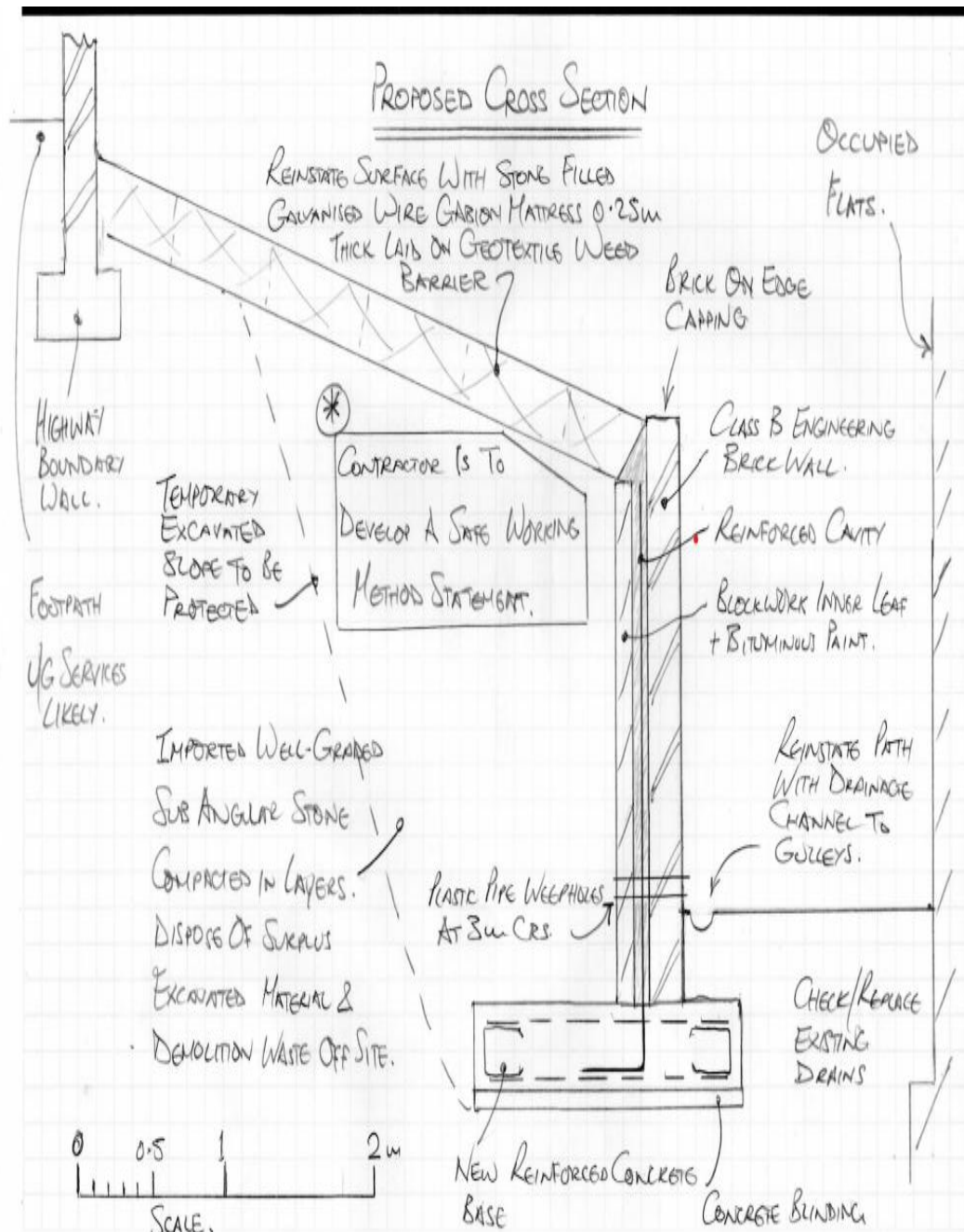

Main walls

## Royal cottages wall design

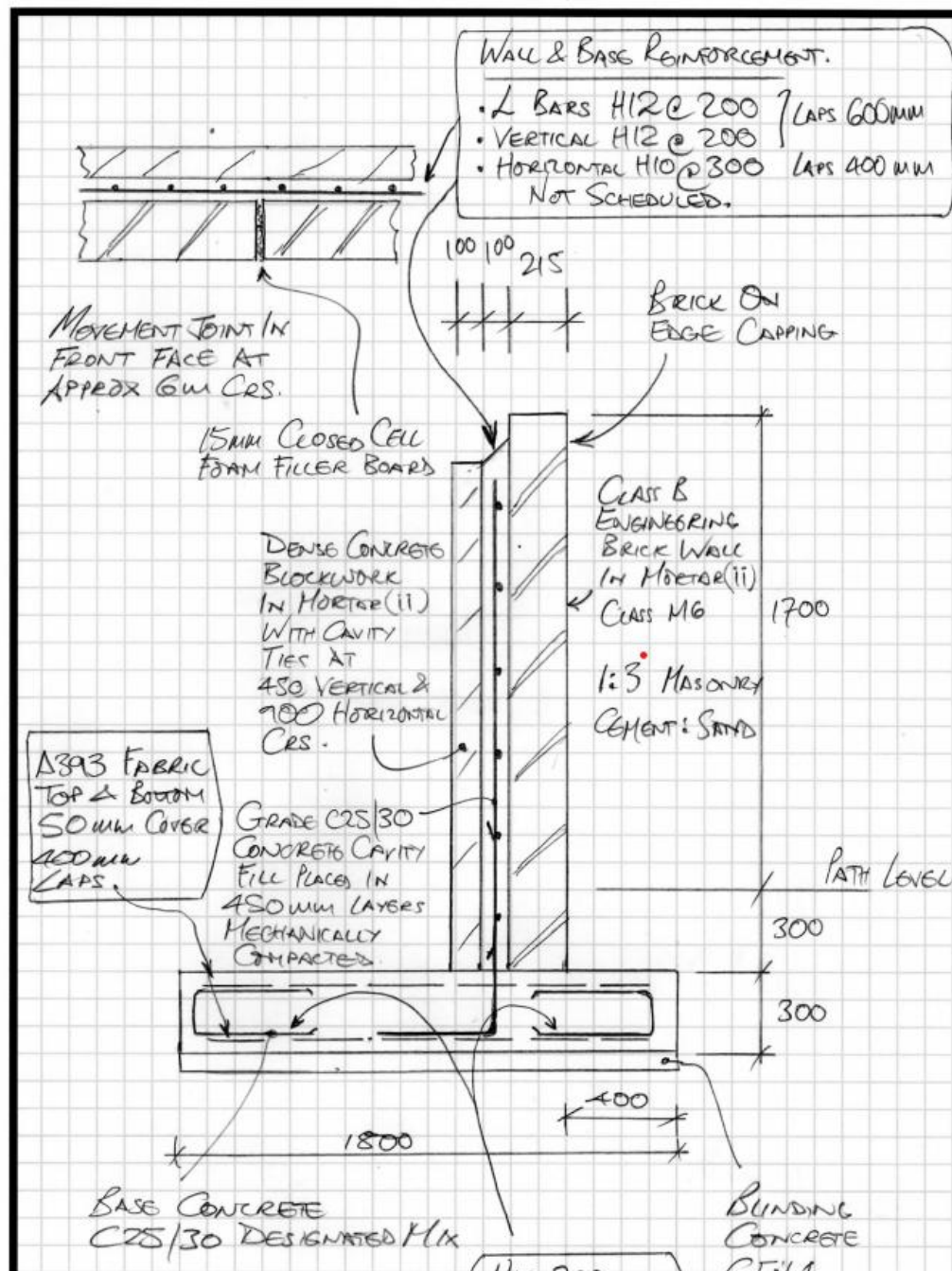

Main walls